

THIS DRAWING IS TO BE READ IN CONJUNCTION WITH SURVEY DRAWING NO 216.2024.000 - SURVEY SITE LAYOUT PLAN & 216.2024.002 - SURVEY SECTIONAL ELEVATIONS AND THE ECOLOGICAL REPORT BY MR.C. WILLS DATED 26.07.2023

**Proposed External Finishes to Dwelling:-**  
**Roof** - Natural Slates (nails not hooks) with grey concrete ridge tiles.  
**Fascias** - Timber  
**Barge Boards** - Timber  
**Rainwater Goods** - Lindab pressed metal Anthracite grey.  
**Walls** - Timber Cladding & Painted Render  
**Windows** - Anthracite grey powder coated aluminium  
**Doors** - Anthracite grey powder coated aluminium

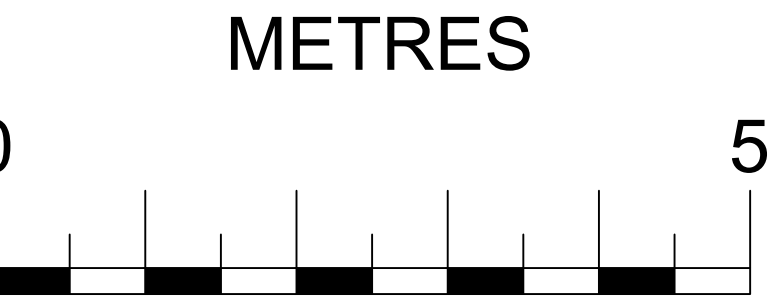

SCALE 1:50

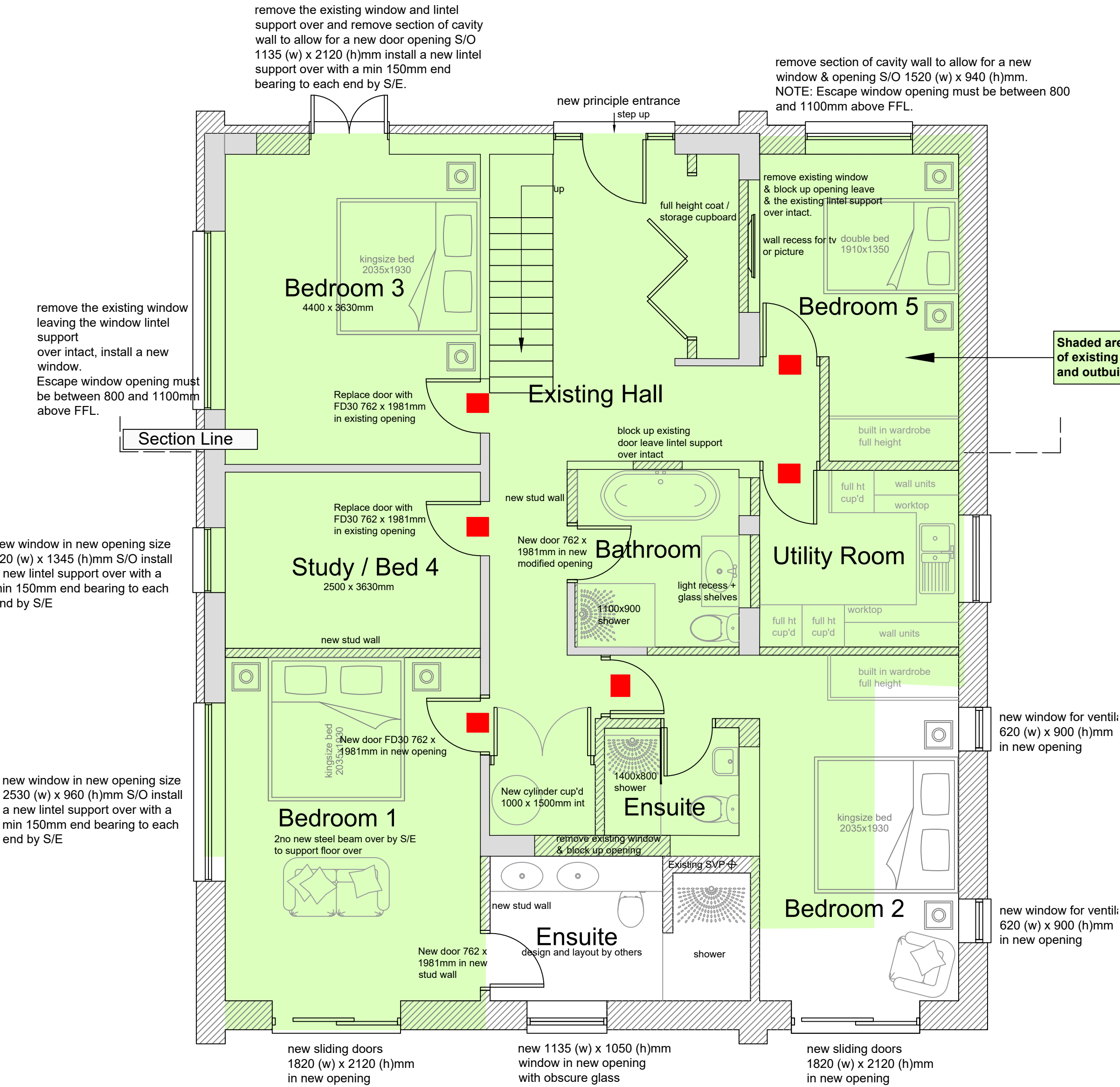

Proposed Ground Floor Plan.  
scale 1:50

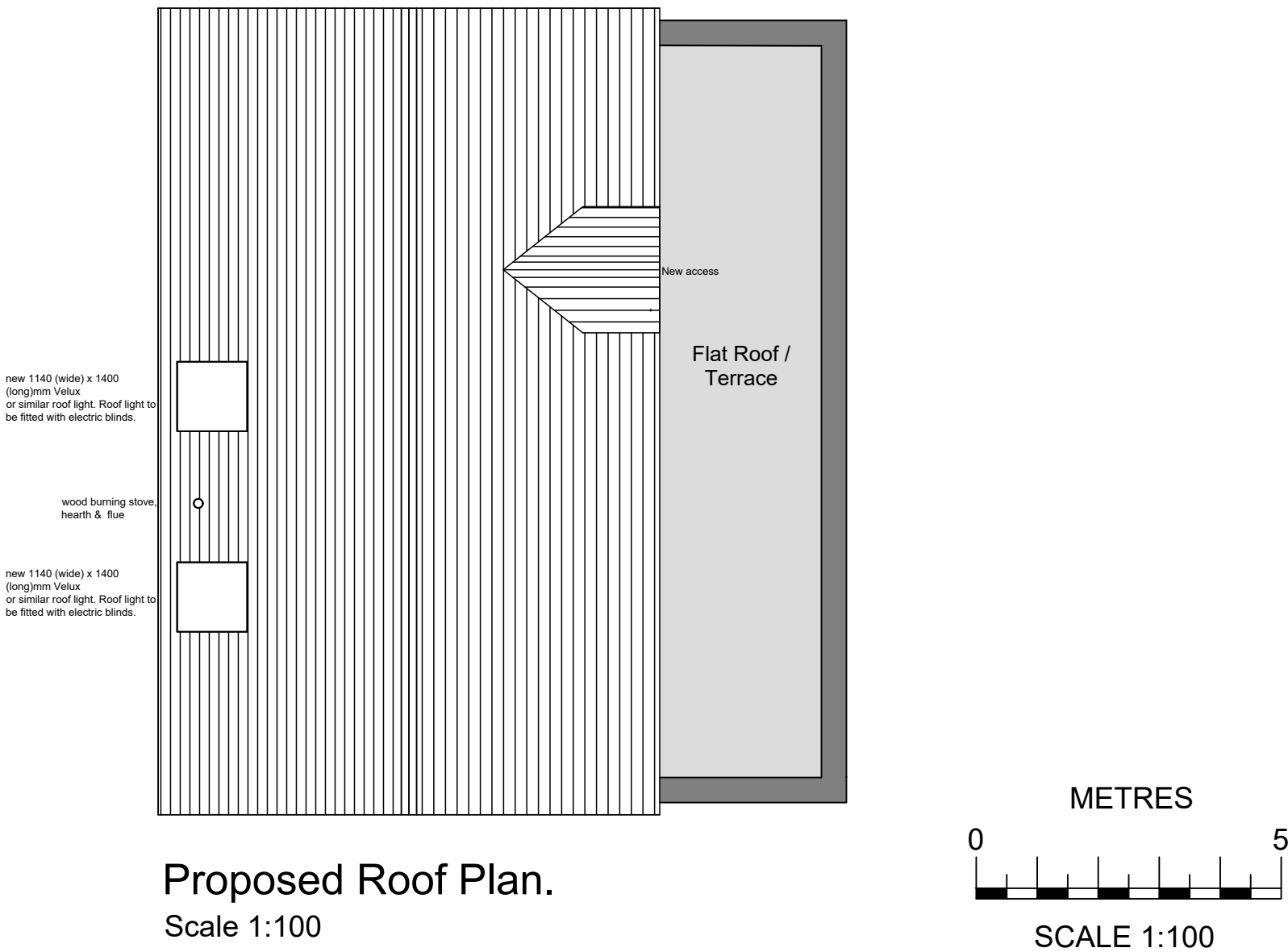

Proposed Roof Plan.  
Scale 1:100

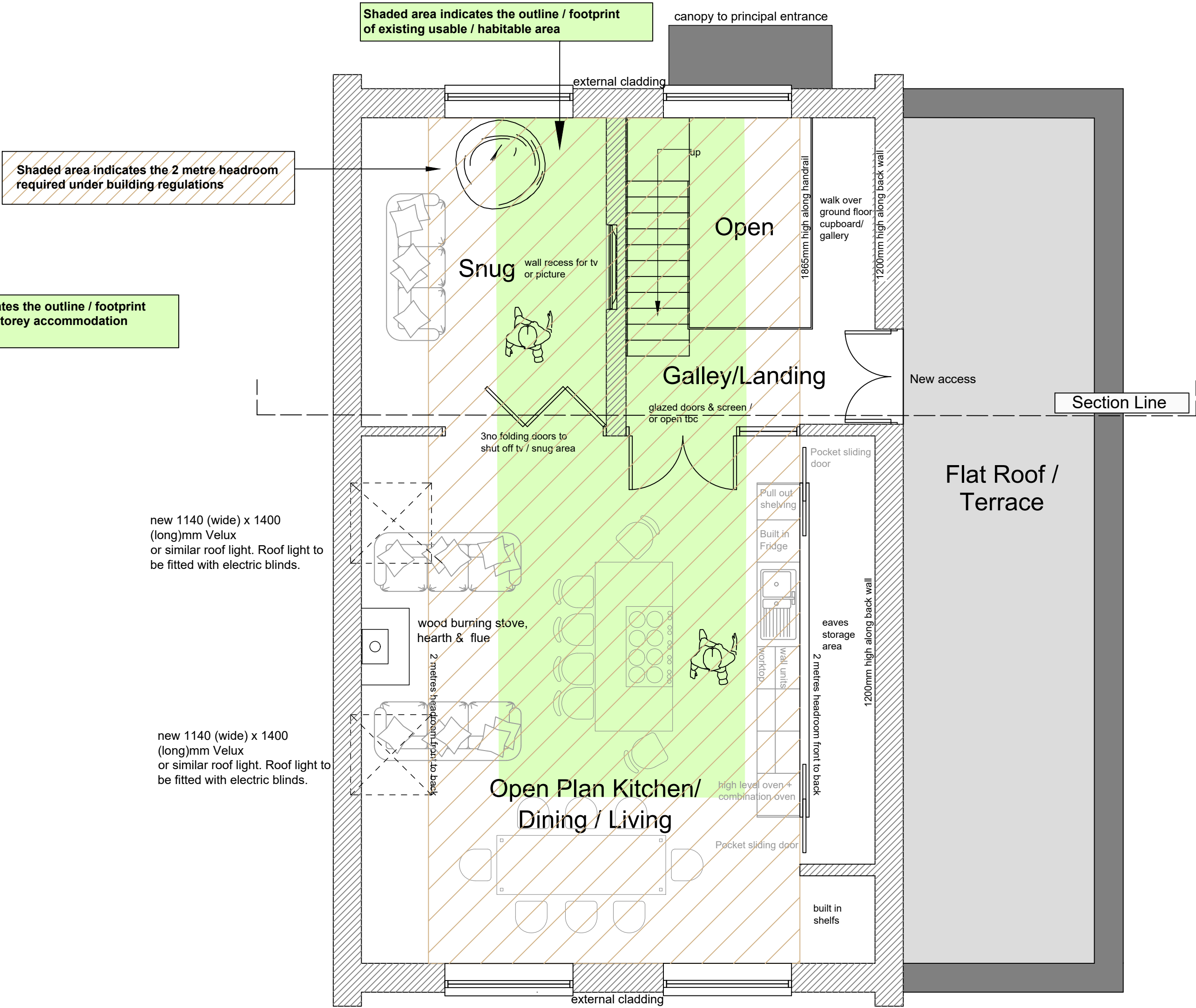

Proposed First Floor Plan.  
Scale 1:50

**NOTE**

All rights described in Chapter IV of the Copyright, Design and Patents Act 1988 have been generally asserted.

Do not scale for construction purposes all dimensions should be checked on site before carrying out any scheme proposals.



**SELENA  
PRYCE  
DESIGNS**

6 Scotts Close, Churchstow,  
Kingsbridge, Devon TQ7 3RB.

Contact: 07835 517387  
Email: selenapryce68@gmail.com



© Copyright  
Client

Job Title

Resubmission of application  
2867/23/HHO for Proposed  
Alterations & Extension  
at Primrose Cottage,  
Aveton Gifford,

Drawing Title

**Scheme (proposed) Drawing:-  
Ground, First and Roof  
Plan.**

Scale

1:50 & :100 @ A1

Date

14.06.2024

Drawn by

S.P

Drg. No.

216.2024.201

Rev.

A

SCHEME (PROPOSED) DRAWING FOR PLANNING PURPOSES